

How to: Change the Lock Barrel (AL Series)



Insert the management key fully into the lock which is missing the key. Turn the key as far as it will go.



Pull the management key out gently so that the lock barrel comes out as well.



Take out the management key, and put into the replacement barrel.

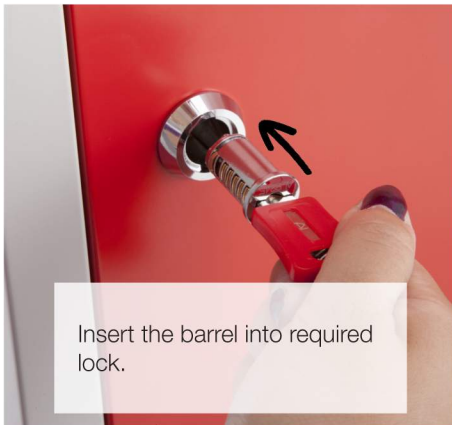

Insert the barrel into required lock.



Push & turn the lock slightly to the right, it will then click into the lock, allowing you to turn it back to the left where it will be fully insert into place.

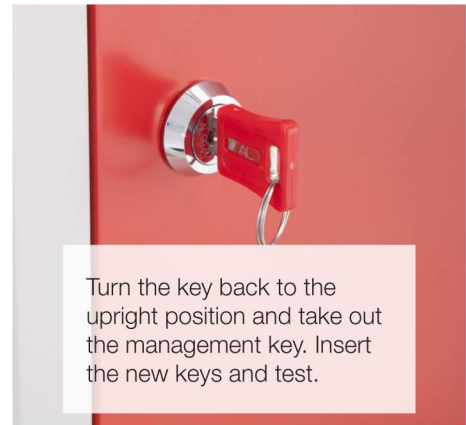

Turn the key back to the upright position and take out the management key. Insert the new keys and test.